

AHU COMPONENT - LOUVRE



Arosio louvers are made of extruded aluminium profiles, joined through zamak corners and screws to guarantee a firm structure. The streamlined blade profile allows for a large free area which will give a low pressure loss. The blade profile takes away the water in channels to the vertical side frames to reduce any water carryover into the air stream. The water is drained to the bottom of the louvre.

Frame and blades are made from extruded aluminium and assembled with quality components. There are two sizes in blade profile 50mm and 100mm which is indicated on the graph.

MATERIALS USED

- **BLADES** extruded aluminium, 50mm (P-GR050) or 100mm (P-GR100) with water drain channels
- **FRAME** extruded aluminium with vertical drain channel, joined with zamak corners and screws
- **PROFILE LENGTH** maximum 6m

PRESSURE LOSS GRAPH

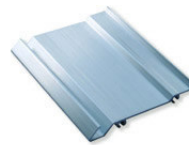
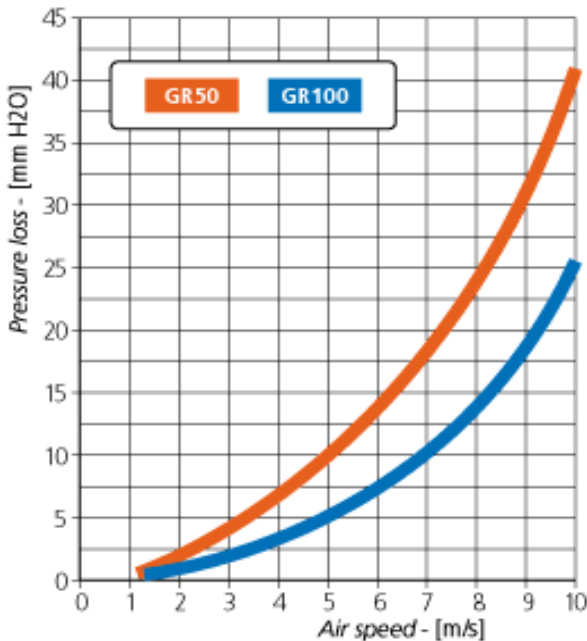

P-GR050-PA

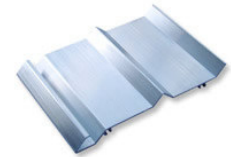

P-GR100-PA

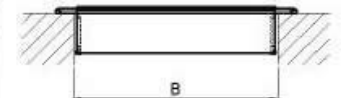
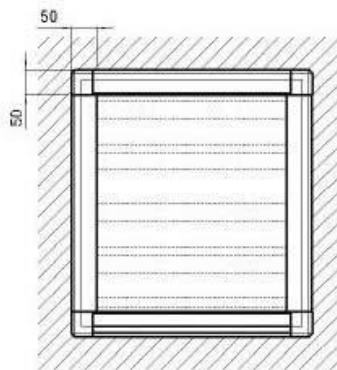
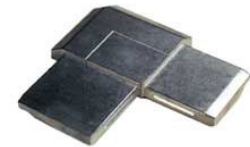
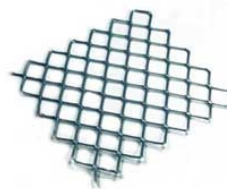

GR050 A = 47.5mm
GR100 A = 80mm
H = Vertical Height + 20mm
B = Width + 10mm

For further information and a quote to suit your application, please contact us